

AVS-840

4U Intel® Xeon® E3-1200V2 Video Wall Controller, Supporting 40-output Video Wall

NEW



Features

- Validated by Matrox
- Support Mura Cards: 10 standard Mura MPX
- Maximum Video Input: 40 Analog/Digital
- Maximum Video Output: 40 Analog/Digital
- Processor: Intel Xeon E3-1200 V2 Series up to 4 cores/8 threads
- Memory : DDR3-1333/1600 MHz (ECC) U-DIMM and 16 GB
- Remote Management: Advantech Remote Monitoring Utility

Specifications

| | | |
|---------------------|--------------------------------|---|
| Processor System | Chipset | Intel C216 Chipset |
| | CPU | Intel LGA 1155 Xeon E3-1200 V2 Single processor (up to 95W TDP) |
| | L3 Cache | 8 MB |
| | Memory | ECC or non ECC DDR3 1333/1600 MHz UDIMMs, maximum 16 GB |
| Graphics | Controller | Chipset integrated Intel HD Graphic (Needs being disabled when Mura MPX is installed) |
| | VRAM | Shared system memory is subject to OS |
| Expansion Slot | Slot Location 1 (PPCIEX4_1) | PClex16 slot (x4 link) |
| | Slot Location 2 (P1PCIEX16_1) | PCIe x16 slot (Gen2 x16 link), for Mura MPX-4/4 installation |
| | Slot Location 3 (P1PCIEX16_2) | PCIe x16 slot (Gen2 x16 link), for Mura MPX-4/4 installation |
| | Slot Location 4 (P1PCIEX16_3) | PCIe x16 slot (Gen2 x16 link), for Mura MPX-4/4 installation |
| | Slot Location 5 (P1PCIEX16_4) | PCIe x16 slot (Gen2 x16 link), for Mura MPX-4/4 installation |
| | Slot Location 6 (P1PCIEX16_5) | PCIe x16 slot (Gen2 x16 link), for Mura MPX-4/4 installation |
| | Slot Location 7 (P2PCIEX16_1) | PCIe x16 slot (Gen2 x16 link), for Mura MPX-4/4 installation |
| | Slot Location 8 (P2PCIEX16_2) | PCIe x16 slot (Gen2 x16 link), for Mura MPX-4/4 installation |
| | Slot Location 9 (P2PCIEX16_3) | PCIe x16 slot (Gen2 x16 link), for Mura MPX-4/4 installation |
| | Slot Location 10 (P2PCIEX16_4) | PCIe x16 slot (Gen2 x16 link), for Mura MPX-4/4 installation |
| | Slot Location 11 (P2PCIEX16_5) | PCIe x16 slot (Gen2 x16 link), for Mura MPX-4/4 installation |
| Drive Bay | 5.25" Front-Accessible | 3 |
| | 3.5" Front-Accessible | 1 |
| | 3.5" Internal | 1 |
| Ethernet | Interface | Dual 10/100/1000 Mbps Gigabit Ethernet |
| | Controller | LAN1: Intel 82579LM LAN2: Intel 82574L |
| Front I/O Interface | USB | 2 x USB2.0 |
| | PS/2 | - |
| Rear I/O Interface | USB | 1 x USB 3.0, 4 x USB2.0 (via USB cable kit) |
| | PS/2 | 1 (Y cable for mouse and keyboard is included in the package) |
| | COM | - |
| | Display | 1 x VGA |
| Watchdog Timer | Output | Interrupt, system reset |
| | Interval | Programmable, 1~255 sec |
| Power Supply | Power Output Wattage | 810W 3+1 redundant power supply (Front-accessible) |
| | Input Range | AC 100 ~ 240 V |
| Cooling | Chassis Fan | 3 (12 cm / 114 CFM each) |
| | Air Filter | 4 (200 x 45 mm) + 1 (128 x 95 mm) |
| Miscellaneous | LED Indicators | Power status, HDD activity, Temperature, Fan, and Power voltage status |
| Environment | Temperature | Operating: 0 ~ 40° C (32~104° F) Non-Operating: -20 ~ 60° C (-4 ~ 140° F) |
| | Humidity | 10 ~ 85% @ 40° C 10 ~ 95% @ 40° C |
| | Vibration (5 ~ 500 Hz) | 1 Grms 2 Grms |
| | Shock | 10G (with 11ms duration, half sine wave) 30G |
| | Physical Characteristics | Dimension |

Dimensions

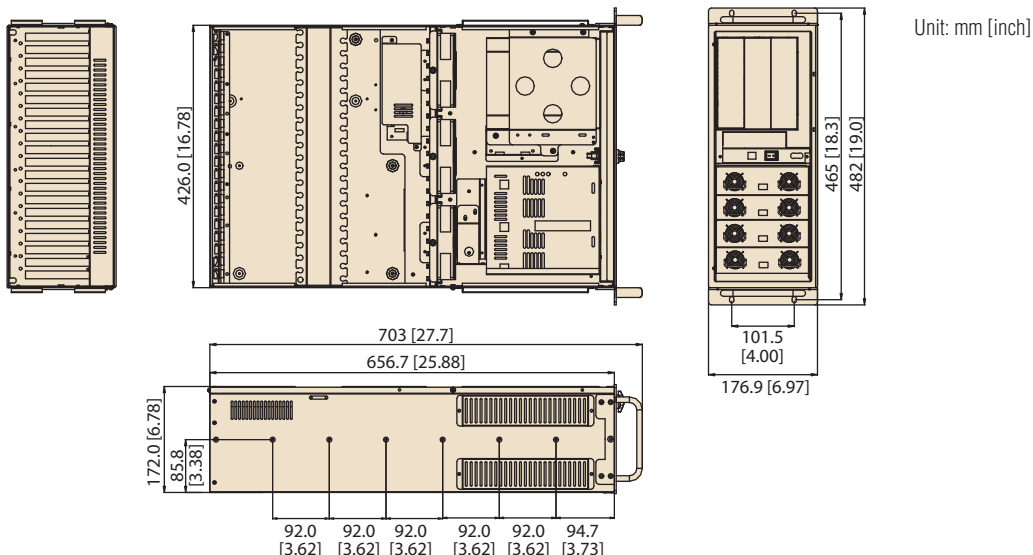

Ordering Information

| Part Number | Power Supply |
|-----------------|--|
| AVS-840-01A1E | 4U Rackmount Xeon E3-1200 v2 Video Wall Controller, Support 10 Matrox Mura MPX |
| 1960047831N001 | PCE-7127 Proprietary CPU Cooler (2U) |
| PCA-AUDIO-HDA1E | Audio extension module |
| PCA-TPM-00A1E | Trusted Platform Module compliant TCG 1.2 |
| 1700020277-01 | 2 ports of USB 3.0 cable w/ BKT(30cm) |
| 1700008822 | DVI-D Cable |

Compatible Processors

| Advantech P/N | Description |
|-------------------|---------------------------------------|
| 96MPXE-3.2-8M11T1 | XEON 3.2G 8M 1155P 4CORE E3-1225V2(G) |
| 96MPXE-3.5-8M11T | XEON 3.5G 8M 1155P 4CORE E3-1275V2(G) |
| 96MPI3-3.3-3M11T1 | CORE 3.3G 3M 1155P 2CORE I3-3220(G) |

System Contents

| Items | Advantech P/N | Quantity |
|------------------|-------------------------------|----------|
| AVS-840 barebone | N/A | 1 |
| Driver CD | 2066512700 | 1 |
| 1701260305 | COM + printer ports cable kit | x1 |
| 1700060202 | Keyboard and mouse Y-cable | x1 |
| 1700008461 | 4-port USB cable kit | x1 |

Validated Matrox Mura Cards

| Advantech P/N | Model | Output | Input |
|-----------------|--------------|--------|-------|
| 96VG-2G-PE-MA | Mura MPX-4/0 | 4 | 0 |
| 96VG-2G-PE-MA1 | Mura MPX-4/2 | 4 | 2 |
| 96VG-2G-PE-MA2 | Mura MPX-4/4 | 4 | 4 |
| 96VG-1G-PE-MA | Mura MPX-SDI | 2 | 2 |
| 96VG-128M-PE-MA | Mura MPX-V8 | 0 | 8 |
| 96VG-256M-PE-MA | Mura MPX-V16 | 0 | 16 |

Front View

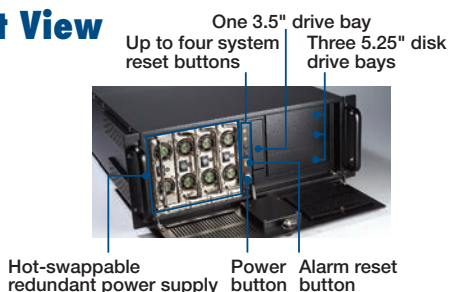

Rear View

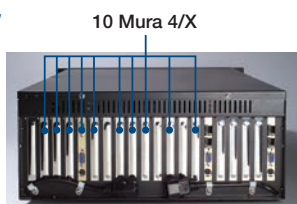

Optional Parts

| Item | Advantech P/N |
|---|--------------------|
| Mobile rack for converting dual 5.25" drive bays to three 3.5" SAS/SATA HDD trays | IDT-5230E |
| Mobile rack for converting a 3.5" drive bay to dual 2.5" SATA HDD trays | IDT-3120E |
| Mobile rack for converting a 5.25" drive bay to four 2.5" SAS/SATA HDD trays | 96RACK-5SS-CAGE-CR |
| SATA cable with lock | 1700003194 |
| ACP-4000 rail kit | 9680006905 |

- Note:
- To support 2 2.5" SATA HDDs RAID with on-board RAID: 1700003194 x 2 + IDT-3120E x 1
 - To support 3 3.5" SATA HDDs RAID with on-board RAID: 1700003194 x 3 + IDT-5230E x 1
 - To support 4 2.5" SATA HDDs RAID with on-board RAID: 1700003194 x 4 + 96RACK-5SS-CAGE-CR x 1

Validated OS

| Advantech P/N | OS for Embedded System |
|---------------|---|
| 968QS28F08 | Windows Server® 2008 with Hyper-V™ Standard 64 Bit |
| 968QSV2845 | Windows Server® 2008 without Hyper-V™ Standard 64 Bit |
| 968QW7PROE | Windows® 7 Professional 64 Bit |