

# CFM-IGN04

CFM Module with Power Ignition Sensing Control Function, 12V/24V Voltage Detection Selectable

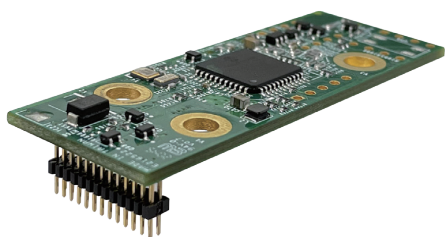

- CFM (Control Function Module) Technology
- Power Ignition Sensing Function
- Various Protection for In-vehicle Applications



## Specifications

Interface	CFM (Control Function Module) Interface
Function	Power Ignition Sensing Function
Vehicle Battery Voltage	12V / 24V
Power-on Delay Duration	5 seconds
Power-off Delay Duration	0 to 2 hours, Support 7 Types of Power Delay-off Timer
Low Voltage Detection	Yes
Dimension( W x D x H )	22 x 59.5 x 11 mm

## Dimensions

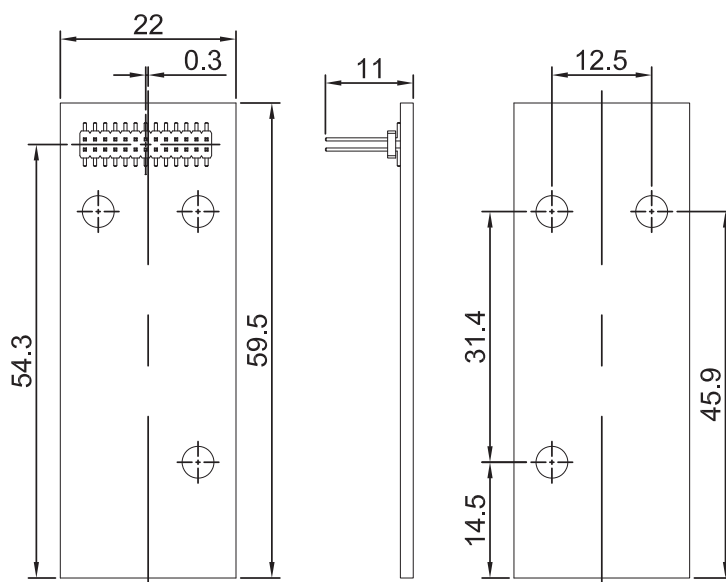

Unit: mm

## Ordering Information

### Available Models

<b>CFM-IGN04-R10</b>	CFM Module with Power Ignition Sensing Function, 12V/24V Selectable
----------------------	---------------------------------------------------------------------

### Package Check List

- CFM Module x1
- Screw Pack x1

## Compatible List

Model No.	CFM-IGN04
DV-1000	V
DV-1100	V

## Assured Systems

Assured Systems is a leading technology company with over 1,500 regular clients in 80 countries, deploying over 85,000 systems to a diverse customer base in 12 years of business. We offer high-quality and innovative rugged computing, display, networking and data collection solutions to the embedded, industrial, and digital-out-of-home market sectors.

### US

[sales@assured-systems.com](mailto:sales@assured-systems.com)

Sales: +1 347 719 4508

Support: +1 347 719 4508

1309 Coffeen Ave  
Ste 1200  
Sheridan  
WY 82801  
USA

### EMEA

[sales@assured-systems.com](mailto:sales@assured-systems.com)

Sales: +44 (0)1785 879 050

Support: +44 (0)1785 879 050

Unit A5 Douglas Park  
Stone Business Park  
Stone  
ST15 0YJ  
United Kingdom

VAT Number: 120 9546 28

Business Registration Number: 07699660