

## 20.1" Marine Bridge System Display

**Model # R20L100-MRA2**

### Features:



- |                                 |  |
|---------------------------------|--|
| ■ Hyper Dimming                 | : Dimming knob control backlight brightness from nearly 0% to 100% |
| ■ Sunlight Readable             | : Transflective film technology enhance visibility                 |
| ■ Anti-Corrosion & IP Proof     | : IP65 aluminum housing with powder coating design (IP54 rear)     |
| ■ Wide Voltage Range Input      | : 9 to 36V DC to DC power input acceptable (AC power for option)   |
| ■ Touchscreen/ Protection Glass | : High quality touchscreen / AR protection glass for option        |
| ■ Multiscan Function            | : PIP(picture in picture) function and multi-video inputs          |
| ■ IP65 OSD Fornt Panel Design   | : Ease of use front panel OSD control                              |
| ■ Anti-Shock and Vibration      | : Enhanced shock and vibration resistance                          |



## Mechanical Design Drawings

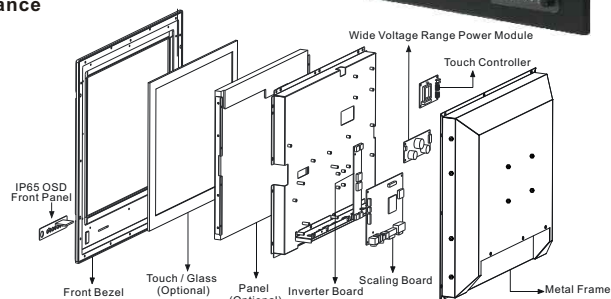
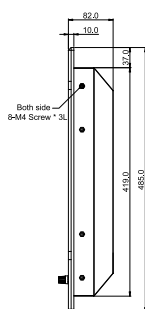
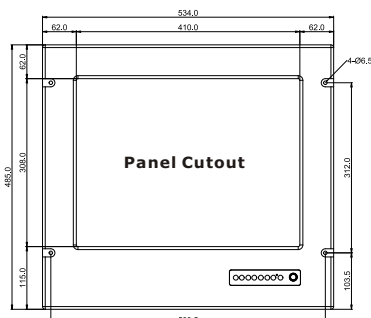

### Modularized Construction

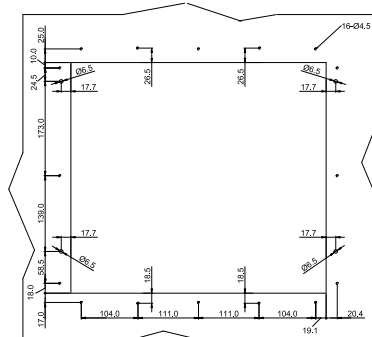
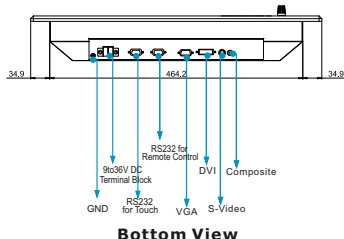
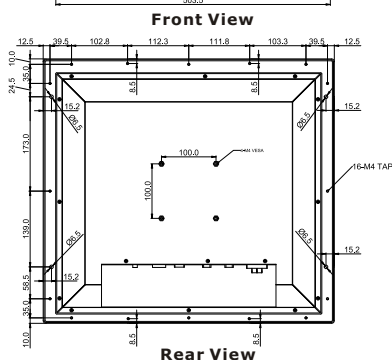

All Dimensions are  $\pm 0.5$  mm

\* Note: this is a simplified drawing and some components are not marked in detail.  
Please contact our sales representative if you need further product information.

### TFT Characteristics:

Pixel Number	: 1600 x 1200
Pixel Pitch(RGB)	: 0.255 (H) x 0.255(V) mm
Contrast Ratio	: 700:1(typ.)
Light Intensity	: 300 cd/m <sup>2</sup> (typ.)
Viewable Angles	: -89~89(H);-89~89(V)
Active Display Area	: 408.0 (H) x 306.0(V) mm
Max Colors	: 16.7M (8bit/colors)

### Input Signals:

RGB Signal	: D-SUB 15P connector(female)
Composite Video	: RCA phono plug
S-Video Signal	: S-Video (SVHS) plug
DVI-D Signal	: DVI-D input 24pin connector
DC Power Signal	: Screw terminal block
AC Power Signal (Optional)	: Std IEC Inlet
Touch Screen (Optional)	: D-SUB 9P connector (female)
Remote via RS-232 (Optional)	: D-SUB 9P connector (female)

### User Controls:

Power On/Off via front button  
VR Brightness Knob Control  
Power Mode Status LED  
On Screen Display control(OSD)  
OSD Remote Control via RS-232

### Power Specifications:

Power Supply Options	: 9 to 36 V DC power supply with Terminal block (Default), 90 to 265V AC powersupply
Power Consumption	: 70 W typical, normal operation

### Mechanical and Environmental:

Mechanical Mounting	: Panel (Flush) mount with IP65*, VESA, Bracket mounting
Operating Temperature	: -10 to 55 deg.C (-20 to 60 deg.C for optional heating)
Operating Humidity	: 5% to 95% (non condensing)
Anti-Vibration	: 5Hz~500Hz / 1Grms/3 Axis
Anti-Shock	: 15G, 11ms duration
* SAW touch for IP54	

**Available Options:**

Touch Screen Options	: SAW, 5 Wire Resistive
AR Safety Glass Options	: 3mm Anti-reflective protection glass
Transflective Options	: Yes (Enhance Visibility)
AC power Options	: Yes (90 to 265 V AC power input)
Bracket Mounting Options	: Yes (One robust bracket can adjust from -10 to 30 deg.)

**Certification and Approvals : CE, FCC**

Note: All Specifications are subject to change without prior notice!



Revised Date : 02/16/2011



**Mechanical Design with Robust Bracket (options)**

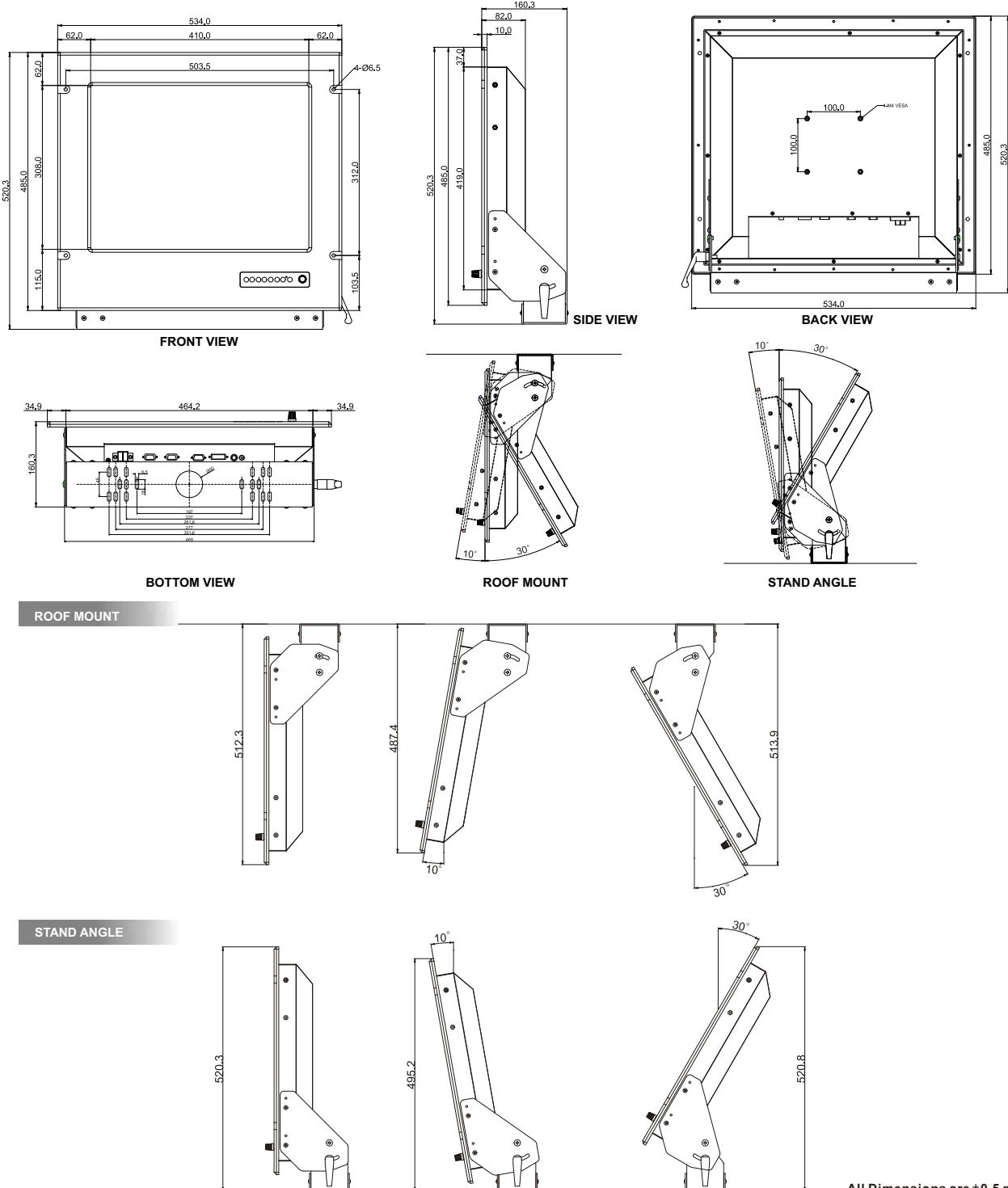

All Dimensions are  $\pm 0.5$  mm

\* Note: this is a simplified drawing and some components are not marked in detail. Please contact our sales representative if you need further product information.



Rev.	Reasons	Revised Date
1.0	Add holes for brackets on back cover*	Nov-17-08
1.1	Spec change	Aug-06-10
1.2	Spec change	Feb-16-11

\* Extra charge is required for back covers with bracket holes for products purchased before end of Nov. 08'

**Certification and Approvals : CE, FCC**

Note: All Specifications are subject to change without prior notice!

**Revised Date : 02/16/2011**

## Assured Systems

Assured Systems is a leading technology company with over 1,500 regular clients in 80 countries, deploying over 85,000 systems to a diverse customer base in 12 years of business. We offer high-quality and innovative rugged computing, display, networking and data collection solutions to the embedded, industrial, and digital-out-of-home market sectors.

### US

[sales@assured-systems.com](mailto:sales@assured-systems.com)

Sales: +1 347 719 4508

Support: +1 347 719 4508

1309 Coffeen Ave  
Ste 1200  
Sheridan  
WY 82801  
USA

### EMEA

[sales@assured-systems.com](mailto:sales@assured-systems.com)

Sales: +44 (0)1785 879 050

Support: +44 (0)1785 879 050

Unit A5 Douglas Park  
Stone Business Park  
Stone  
ST15 0YJ  
United Kingdom

VAT Number: 120 9546 28

Business Registration Number: 07699660