

LPC-P170S-10

17" P-cap Panel PC with Celeron® N3160, IP65 / 66 Bezel-Free and Wide Range Power Input



Lockable HDD Tray

Features

- ▶ Celeron® N3160 Quad Core 1.6GHz
- ▶ IP65 / 66 Front Panel
- ▶ Bezel-Free Design
- ▶ 17" P-cap Flat Bezel
- ▶ Fanless Design
- ▶ 3-Pin Power Input Terminal Block
- ▶ DC 9~36V Wide Range Power Input
- ▶ 1280*1024 Resolution
- ▶ 350 nits LED Backlight
- ▶ 1000 nits LED Backlight (Optional)
- ▶ Lockable HDD Tray
- ▶ Optional to Resistive Touch
- ▶ -20°C Cold Start

Specification



System	
Processor	Intel® Celeron® N3160 SoC CPU
System Memory	DDR3L SO-DIMM, up to 8 GB
External I/O Port	4 x USB 3.0 2 x GbE LAN (RTL8111G) 1 x Display Port 1 x HDMI 3 x RS-232 1 x RS-232/422/485 1 x Audio 1 x Power press button 1 x 3-Pin Power Input 1 x Lockable HDD Tray
Storage	1 x SATA3 (6.0Gb/s) 1 x mSATA (full size mini-PCIe)
Operating System	Windows 7 Pro, Windows Embedded Standard 7, Windows 8, Windows 10
Expansion	2 x MiniPCIe Slot

Power Requirement	
Power Type	3-Pin Power Input Terminal Block DC 9~36V Wide Range Power Input

Touch Screen	
Type	17" P-cap USB

LCD	
Display Type	17" TFT-LCD
Max. Resolution	1280*1024
Max. Color	16.7 M
Luminance	350 nits
View Angle	85/85/80/80
Backlight Lifetime	30,000 hours

Mechanical	
Construction	Metal
IP Rating	Front Panel IP65 Front Panel IP66 Compliant
Mounting	VESA / Panel Mount
Dimension	TBC

Environment	
Operating Temp	-20~60 °C IEC-60068-2-1/2/14
Storage Temp	-20~60 °C
Humidity	10~90% @40 °C, non-condensing
EMC	FCC / CE Class A Certification CE Class B Compliant
Vibration	1.5 Grms @10~500Hz, IEC-60068-2-64



Dimension & I/O Connector

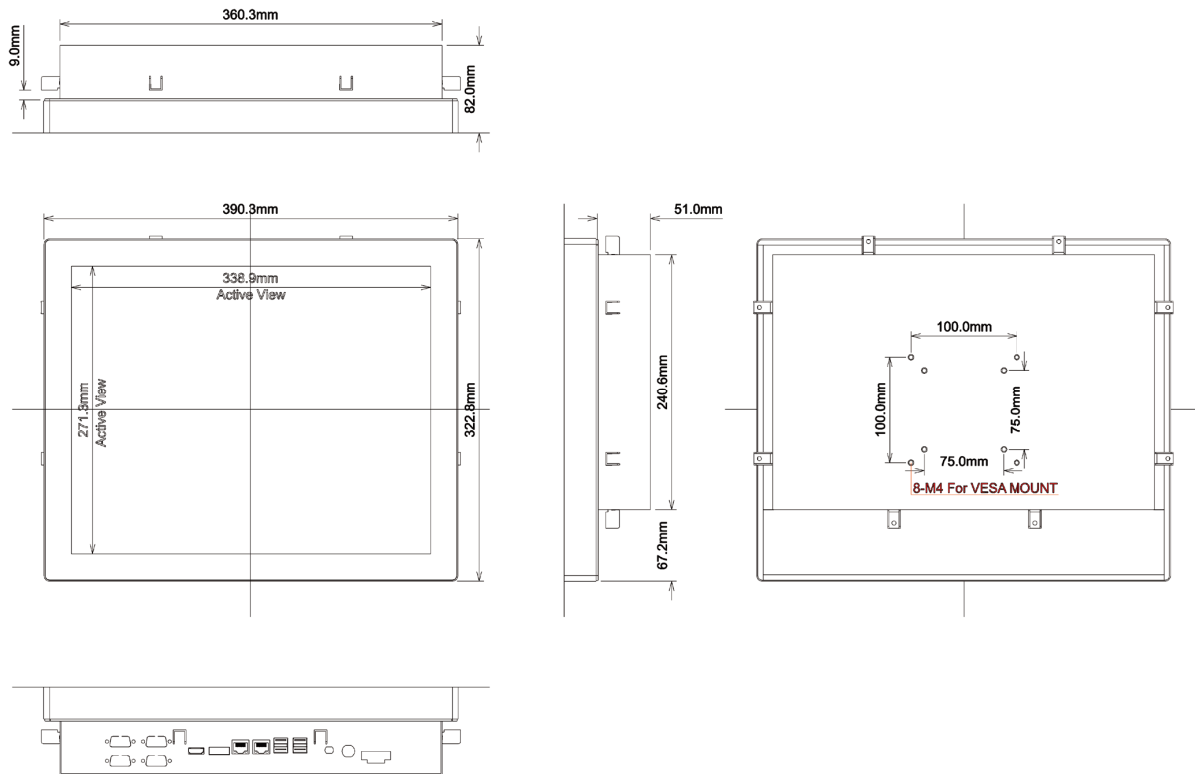

Ordering Information

LPC-P170S-10	17" P-cap Panel PC, Celeron® N3160, 1280 x 1024 Reso, 350 nits, DC 9~36V Power Input, including a 3-Pin Power Adapter (12V/7.5A)
WFK-024	WiFi kits w/ cable & Antenna (2.4GHz, 802.11 b/g/n, 1T1R)
WFK-524	WiFi kits w/ cable & Antenna (2.4 & 5GHz, 802.11 a/b/g/n/ac + BT, 2T2R)
04-US-26-00002	120 W / 24V power adapter with 3 pin terminal block (For High Brightness Model)

Ordering Code

LPC-P170S-10 -H / -OB / -B / -AG / -AR / -9 / -V

H = High Brightness 1000 nits LED backlight

OB = Optical Bonding

B = Glass without touch

AG = Anti-Glare

AR = Anti-Reflection

9 = Power Board for Input on board fuse / Input reverse protection / Over current protection / Output short circuit protection

V = Vandal Proof Glass

Assured Systems

Assured Systems is a leading technology company with over 1,500 regular clients in 80 countries, deploying over 85,000 systems to a diverse customer base in 12 years of business. We offer high-quality and innovative rugged computing, display, networking and data collection solutions to the embedded, industrial, and digital-out-of-home market sectors.

US

sales@assured-systems.com

Sales: +1 347 719 4508
Support: +1 347 719 4508

1309 Coffeen Ave
Ste 1200
Sheridan
WY 82801
USA

EMEA

sales@assured-systems.com

Sales: +44 (0)1785 879 050
Support: +44 (0)1785 879 050

Unit A5 Douglas Park
Stone Business Park
Stone
ST15 0YJ
United Kingdom

VAT Number: 120 9546 28
Business Registration Number: 07699660