



Clinical Review Monitor  
**RadiForce<sup>®</sup> MX242W**



A 24.1-inch widescreen monitor with DICOM Part 14 calibration support, smooth color reproduction, and screen management for increased work efficiency.

- Optimal viewing of medical DICOM grayscale images
- Image accuracy and consistency over time with DICOM Part 14 calibration
- Low power consumption and long lifetime with LED backlight
- Increased work efficiency with widescreen
- Minimal color and contrast shift when viewed from an angle
- Consistent display with automatically stabilized brightness
- Stable images across the screen with brightness uniformity
- Smooth color gradation with over 1 billion colors displayed
- Ideal preset modes for CR, CT, MRI, and endoscope images
- Guaranteed usage time of 5 years or 15,000 hours at 180 cd/m<sup>2</sup>



## RadiForce® MX242W

### Make the Precise Diagnosis

EIZO carefully measures and sets each grayscale tone to create a monitor compliant with DICOM Part 14. This ensures the most consistent shading possible, allowing for the most accurate diagnosis.

### Maintain the Precision

Perform a simplified calibration compliant with DICOM Part 14 using the bundled RadiCS LE quality control software. RadiCS LE corrects the brightness and grayscale tones of the monitor to maintain image accuracy and consistency over time.

### Keep Your Monitor Lit Longer

The LED backlight offers a significantly longer service life over conventional CCFL backlights. In addition, you can maintain high brightness while simultaneously lowering power consumption. Since the LED backlight is mercury-free, it will also reduce any potential impact on the environment when disposed of.

### View More with Widescreen

The widescreen 16:10 aspect ratio provides significantly more horizontal space than the aspect ratios of conventional square monitors so that you can keep tool palettes open without covering the window you are working on.

### Comfortably View from Any Angle

The wide viewing angles of the IPS panel allow you to view the screen from the side with minimal color shift, also permitting more than one person to view the monitor comfortably at the same time.

### View Accurate Images in Moments

The EIZO-patented drift correction function quickly stabilizes the brightness level of the monitor upon startup or wakeup from sleep mode, giving you the most accurate images quickly ready for viewing. In addition, a sensor measures the backlight brightness fluctuations caused by ambient temperature and aging for a consistently stable display.

### Attain Steady Images Across the Screen

The Digital Uniformity Equalizer (DUE) function helps to even out fluctuations in brightness and chroma on different parts of the screen to provide smoother images.

### Gain Smooth Color Reproduction

The monitor can support 10-bit input for each RGB color, displaying more than one billion colors simultaneously. This ensures accurate reproduction of color tones for 3D color rendering and image fusion.

### Select the Ideal Mode for Modalities

The CAL Switch function allows you to choose various modes for different modalities such as CR, CT, MRI, and endoscopy and can be conveniently accessed using the monitor's front panel buttons.

### Stay Confident with Stable Brightness

EIZO's confidence in its product quality extends to brightness stability. 5 years or 15,000 hours of usage time is guaranteed when used at the recommended brightness of 180 cd/m<sup>2</sup>.

## Specifications

Cabinet Color	Black
Panel	Type: Color TFT LCD Panel (IPS)
	Backlight: LED
	Size: 61 cm / 24.1" (611 mm diagonal)
	Native Resolution: 1920 x 1200 (16:10 aspect ratio)
	Viewable Image Size (H x V): 518.4 x 324.0 mm
	Pixel Pitch: 0.270 x 0.270 mm
	Display Colors: 10-bit colors (DisplayPort) : 1.07 billion (maximum) colors 8-bit colors: 16.77 million from a palette of 68 billion colors"
	Viewing Angles (H / V, typical): 178° / 178°
	Brightness (typical): 350 cd/m <sup>2</sup>
	Contrast Ratio (typical): 1000:1
	Response Time (typical): 12 ms (On/Off)
Video	Input Terminals: DVI-I x 1, DisplayPort x 1
Signals	Digital Scanning Frequency (H / V): 31 - 76 kHz / 59 - 61 Hz Analog Scanning Frequency (H / V): 26 - 76 kHz / 49 - 71 Hz Sync Formats: Separate
USB	Function: 1 upstream, 2 downstream Standard: Rev. 2.0
Power	Power Requirements: AC 100 - 240 V: 50 / 60 Hz Maximum Power Consumption: 68 W Typical Power Consumption: 31 W Power Save Mode: Less than 0.5 W Power Management: Digital: DVI DMPM, DisplayPort 1.1a Analog: VESA DPM
Sensor	Backlight Sensor
Features & Functions	Brightness Stabilization: Yes Digital Uniformity Equalizer: Yes Preset Modes: CAL Switch OSD Languages: English, German, French, Italian, Japanese, Simplified Chinese, Spanish, Swedish, Traditional Chinese
Physical	Net Weight: 8.7 kg
Specifications	Net Weight (Without Stand): 6.0 kg Hole Spacing (VESA Standard): 100 x 100 mm
Certifications & Standards	CE (Medical Device Directive), EN60601-1, UL60601-1, CSA C22.2 No. 601-1, IEC60601-1, VCCI-B, FCC-B, Canadian ICES-003-B, RCM, RoHS, China RoHS, WEEE, CCC, GOST-R (Please contact the EIZO group company or distributor in your country for the latest information.)
FDA 510(k) Clearance	Yes (for General Radiography*)
Supplied Accessories	AC power cord, signal cable (DVI-D - DVI-D, DisplayPort - DisplayPort), USB cable, Utility Disk (RadiCS LE, ScreenManager Pro for Medical, PDF instructions for use, PDF installation manual), instructions for use
Warranty	Five Years

\*Display of mammography images for diagnosis is not supported.

## Dimensions (Unit: mm)

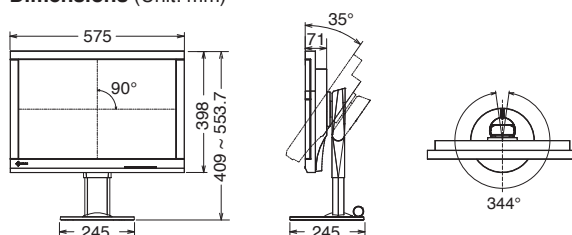

## EIZO Corporation

153 Shimokashiwano, Hakusan, Ishikawa 924-8566 Japan

Phone +81-76-277-6792 Fax +81-76-277-6793

[www.eizo.com](http://www.eizo.com)

All product names are trademarks or registered trademarks of their respective companies. EIZO, RadiForce, RadiCS, and RadiNET are registered trademarks of EIZO Corporation. Specifications are subject to change without notice.

Copyright© 2015 EIZO Corporation. All rights reserved. (140907B)

## Assured Systems

Assured Systems is a leading technology company with over 1,500 regular clients in 80 countries, deploying over 85,000 systems to a diverse customer base in 12 years of business. We offer high-quality and innovative rugged computing, display, networking and data collection solutions to the embedded, industrial, and digital-out-of-home market sectors.

### US

[sales@assured-systems.com](mailto:sales@assured-systems.com)

Sales: +1 347 719 4508

Support: +1 347 719 4508

1309 Coffeen Ave  
Ste 1200  
Sheridan  
WY 82801  
USA

### EMEA

[sales@assured-systems.com](mailto:sales@assured-systems.com)

Sales: +44 (0)1785 879 050

Support: +44 (0)1785 879 050

Unit A5 Douglas Park  
Stone Business Park  
Stone  
ST15 0YJ  
United Kingdom

VAT Number: 120 9546 28

Business Registration Number: 07699660